

Reference projects

Bridges



Renovation of Le Tirage bridge, Valangin NE

A new bridge to cross the Seyon in Valangin! The new bridge links Rue du Saut to the wooded hillside above Valangin. It can support loads of up to 40 tonnes., Valangin NE



New construction of Wühri Bridge, Horrenbach-Buchen

The new wooden bridge connects the two Bernese villages of Horrenbach-Buchen and Teuffenthal near Thun and replaces an old concrete bridge. The new crossing is capable of carrying loads of up to 32 tons., Horrenbach-Buchen



Wildlife transfer Rynetel, Suhr

It took a long time to convince people: more than 20 years ago, Stefan Zöllig demonstrated that wood is the right choice of construction material for wildlife bridges. Today, the wooden bridge over the A1 highway between Suhr and Hunzenschwil is impressive., Suhr



Wildlife transfer Neuenkirch, Luzern

In Neuenkirch, the Federal Roads Office FEDRO is already building the second wildlife bridge with a wooden overpass after the Rynetel wildlife bridge. The wildlife overpass in the canton of Lucerne has a width of 50 meters and a length of around 36 meters., Luzern



The Tüfisteg pedestrian and bicycle bridge, Adliswil

The Tüfisteg pedestrian and bicycle bridge in Adliswil is getting on in years. Analyses showed that replacing the bridge would cost almost as much as renovating it. Today, a new bridge leads over the Sihl - with beech wood from the surrounding forests., Adliswil



Wooden bridge Sihlmatt, Hirzel

The Sihlmatt wooden bridge has connected the cantons of Zug and Zurich since its construction in 1849-1850. Timbatec Holzbauingenieure AG has determined by means of a condition survey that the bridge urgently needs to be rehabilitated and subsequently supervised the repair project., Hirzel



Access bridge museum, Murten

Forty years after its construction, the pedestrian bridge leading to the Murten Museum was no longer in good condition and needed to be replaced. The new passerelle, designed by Timbatec, is made of durable larch wood from Swiss forests., Murten



New bicycle and pedestrian bridge over the old Aare river, Lyss

A new bridge in Lyss should be wider than the old one and passable for bicycles. Nevertheless, it will be supported by the existing abutments., Lyss



Safe passage to the wilderness park, Horgen-Sihltalstrasse

Large parts of the Horgen pedestrian bridge over the Sihltalstrasse had to be replaced. Many central wooden elements of the crossing were in poor condition., Horgen-Sihltalstrasse



Safe passage to the wilderness park, Horgen-Sihltalstrasse

Large parts of the Horgen pedestrian bridge over the Sihltalstrasse had to be replaced. Many central wooden elements of the crossing were in poor condition., Horgen-Sihltalstrasse



Renovation Steinbach Bridge, Trubschachen

The covered wooden bridge at the exit of Trubschachen leads over the Ilfis and provides access to the Steinbach and Buhus area. Although it does not have to carry a great deal of traffic, it does sometimes have to carry quite heavy vehicles., Trubschachen



Höllbach Bridge, Plasselb

The bridge connects the districts of Sense and Gruyères and received a certificate for the use of Swiss wood. The new truss structure with shingle roof replaces the old Höllbach bridge, which was destroyed by arson in 2013., Plasselb



Höllbach Bridge, Plasselb

The bridge connects the districts of Sense and Gruyères and received a certificate for the use of Swiss wood. The new truss structure with shingle roof replaces the old Höllbach bridge, which was destroyed by arson in 2013., Plasselb



Connecting bridge Thommen Furler, Rüti bei Büren, Bern

A pipeline bridge had to be designed for the transport and filling of the chemicals from the storage facilities via the warehouses to the railroad tracks, which would withstand the high demands of the chemicals such as acids and alkalis., Rüti bei Büren, Bern



Redevelopment - pedestrian bridge, Vechigen

The pedestrian bridge near Vechigen was built in 1999. From the outside it was in relatively good condition, only the upper covers of the main girders seemed weathered and damaged., Vechigen



New construction bridge park Gries, Volketswil

In order to offer the public more recreational and sports opportunities, the political municipality of Volketswil realized an expansion and redesign of this sports and recreational facility., Volketswil

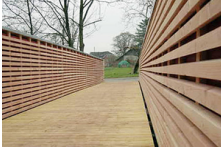

New construction of Suhresteg, Buchs AG

The competition for the replacement of the Suhr bridge was won by the Erne/Timbatec/Moser+Colombo team in the fall of 2005., Buchs AG

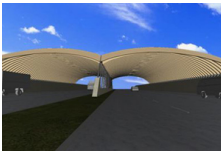

Preliminary project wildlife overpasses A1 and T5, Suhr

The construction of roads and railroad lines has cut up and reduced the existing wildlife habitat. The green bridges serve to reconnect these habitats at important points., Suhr



New construction Geissegg bridge, Eriz and Horrenbach-Buchen

The communities of Eriz and Horrenbach/Buchen needed to replace the old, dilapidated concrete trough bridge. The choice quickly fell on wood as a building material., Eriz and Horrenbach-Buchen



Renovation Rütigrundbrücke, Rüscheegg BE

On behalf of the Civil Engineering Office of the Canton of Bern, the task was to assess the condition of the Rütigrund Bridge, to prepare a rehabilitation concept and to supervise the rehabilitation on site. Furthermore, the 136-year-old bridge was to be largely preserved and integrated into its surroundings., Rüscheegg BE

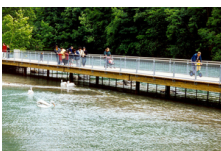

Pedestrian footbridge Dählhölzli Zoo, Bern

The Aare burst its banks in May 1999 in the course of a flood of the century and also caused considerable damage to the zoo., Bern



Renovation Lower Schwand Bridge, Rüscheegg BE

On behalf of the Civil Engineering Office of the Canton of Bern, the task was to assess the condition of the Lower Schwand Bridge, to prepare a rehabilitation concept and to supervise the rehabilitation on site. Furthermore, the 133-year-old bridge was to be largely preserved and integrated into its surroundings., Rüscheegg BE

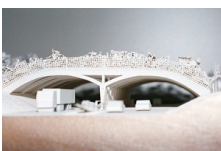

Project study green bridge Chüsenrain, Neuenkirch

Building a green bridge in wood over a four-lane highway is a special challenge. Even though a lot of water will still be flowing down the Reuss until the groundbreaking ceremony, the study that has been prepared shows approaches for a safe and durable solution., Neuenkirch



Bicycle bridge over the Töss, Wülflingen

During a flood in the 1960s, the old footbridge at the confluence of the Eulach and the Töss was destroyed. This was not replaced at first. It was not until residents of the adjacent neighborhoods submitted a petition for a new pedestrian footbridge in 1989 that the project planning for a new footbridge was taken in hand., Wülflingen



Bicycle bridge over the Töss, Wülflingen

During a flood in the 1960s, the old footbridge at the confluence of the Eulach and the Töss was destroyed. This was not replaced at first. It was not until residents of the adjacent neighborhoods submitted a petition for a new pedestrian footbridge in 1989 that the project planning for a new footbridge was taken in hand., Wülflingen